

AES #503

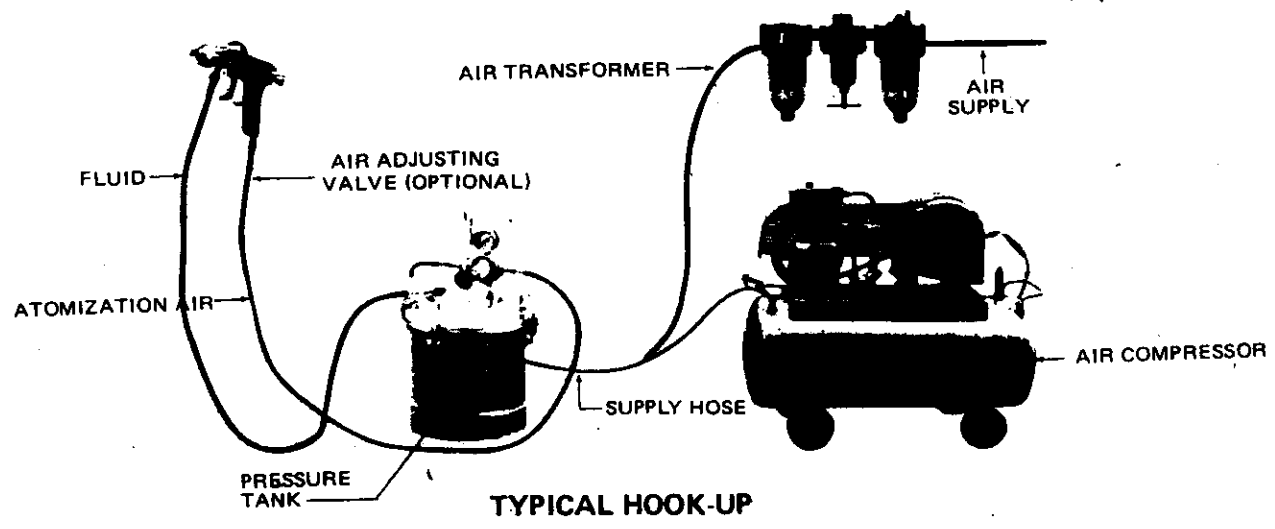

OPERATION

1. Turn on the air supply.
2. Turn Tee-Handle adjusting screw clockwise on the tank regulator to increase material pressure; turn it counter-clockwise to decrease pressure. Maximum tank pressure is 80 PSI.
3. Atomization air for the spray gun can be adjusted at the gun by means of an air adjusting valve or adding an air regulator kit to the tank. See accessories.
4. Operate Spray Gun according to instructions accompanying gun.

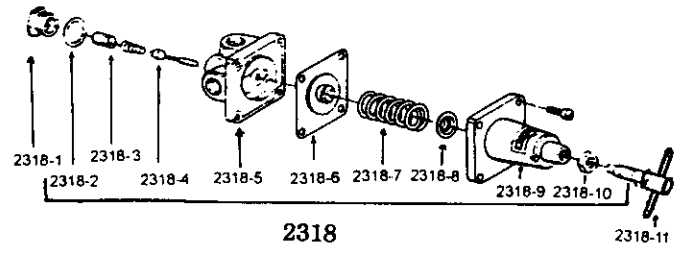

REGULATOR (NO. 6)

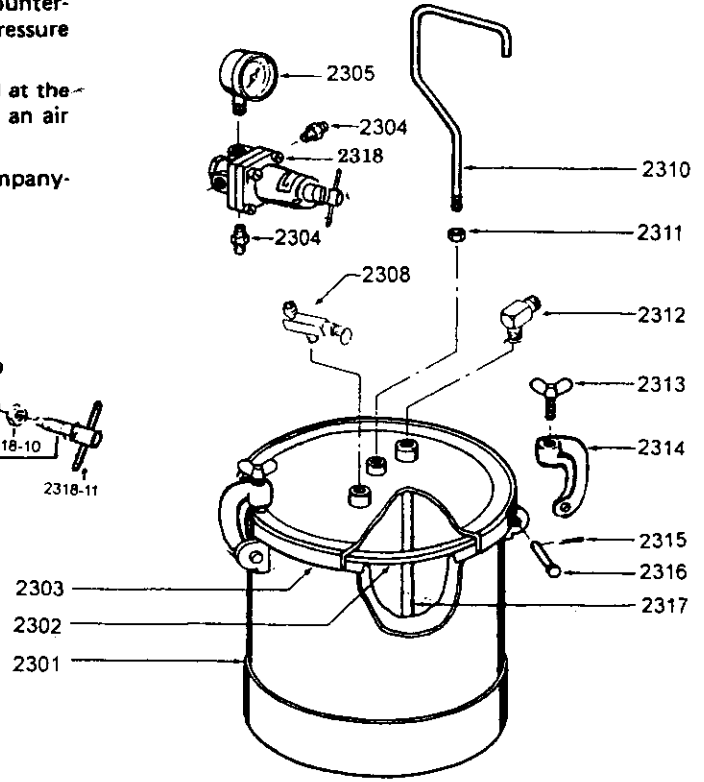

2 1/4-GALLON PRESSURE TANK

| Number | Part | Quantity |
|--------|---------------------|----------|
| 2301 | Tank Shell Assembly | 1 |
| 2302 | Lid Gasket, | 1 |
| 2303 | Lid Assembly | 1 |
| 2304 | Adapter | 3 |
| 2305 | Gauge | 1 |
| 2308 | Swivel Adapter, | 1 |
| 2310 | Handle. | 1 |
| 2311 | Hex Nut | 1 |
| 2312 | Street Elbow | 1 |
| 2313 | Thumb Screw | 4 |
| 2314 | Yoke Assembly | 4 |
| 2315 | Cotter Pin | 4 |
| 2316 | Hinge Pin | 1 |
| 2317 | Fluid Tube | 1 |
| 2318 | Air Regulator | 1 |

MAINTENANCE: CLEANING EQUIPMENT

1. Turn off the main air supply to the tank.
2. Relieve all pressure from the tank by pulling the ring on safety valve until the pressure bleeds down.
3. Turn T-handle adjusting screw on tank regulator counterclockwise until no spring tension is felt.
4. Loosen thumb screws, tip clamps back and tip tank lid to one side.
5. Loosen spray gun air cap retaining ring about three turns.
6. Turn on the air supply.
7. Cup cloth over air cap on the gun and pull trigger. This will force material back through the hose, into the tank.
8. Empty and clean tank and parts which come in contact with material. Use a suitable solvent.
9. Pour solvent into the tank.
10. Replace lid and tighten thumb screws and clamps.
11. Spray until clean solvent appears.
12. Repeat steps 4-7.

Note: Keep the safety valve clean at all times.