

7" Vertical Polisher

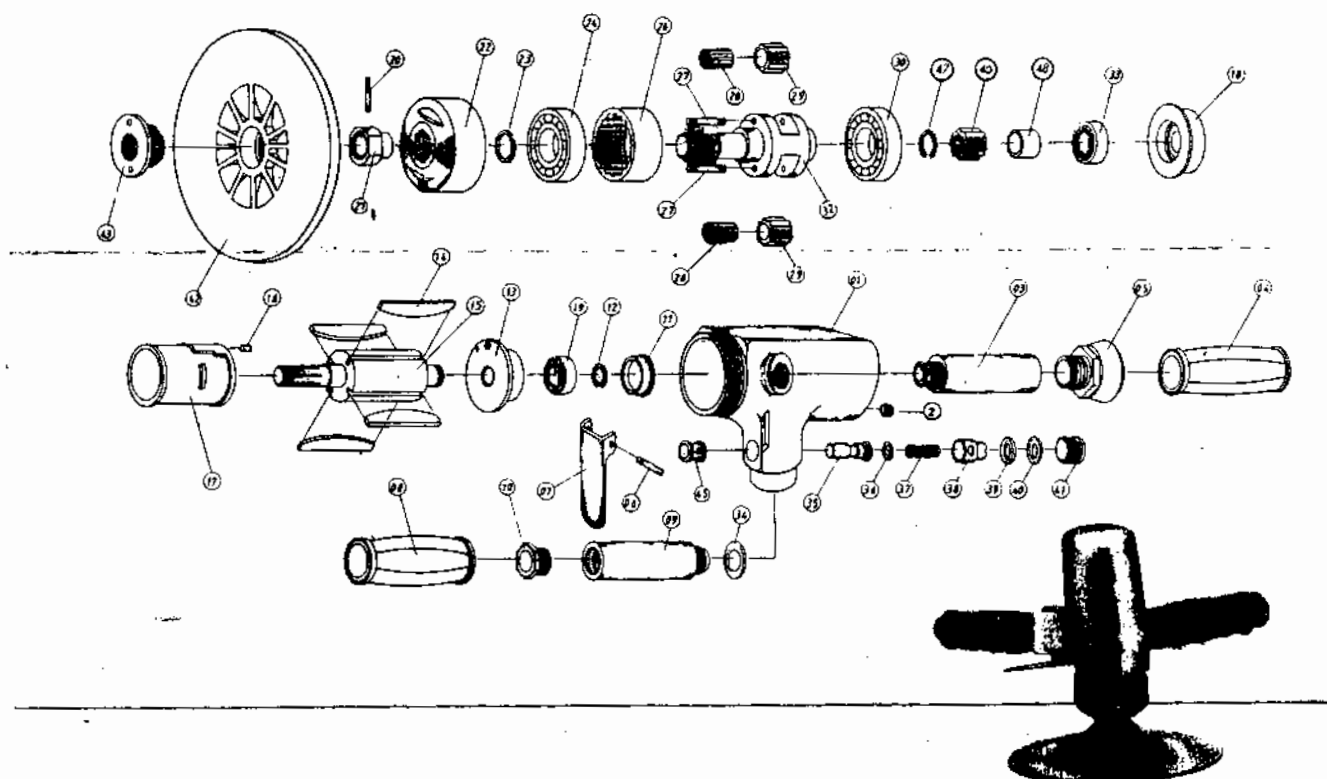

REF NO.	PARTS NO	DESCRIPTION
01	VP-70001	Motor Housing
02	VP-70002	Set Screw
03	VP-70003	Exhaust Handle
04	VP-70004	Handle Grip
05	VP-70005	Exhaust Deflector
06	SP-25220	Spring Pin
07	AR-38005	Throttle Lever
08	VP-70008	Handle Grip
09	VP-70009	Inlet Handle
10	VP-70010	Inlet Bushing
11	VP-70011	Bearing Cap
12	STW-008	External Stop Ring
13	VP-70013	Rear End Plate
14	VP-70014	Rotor Blade (4 Req'd)
15	VP-70015	Rotor
16	SP-30060	Spring Pin
17	VP-70017	Cylinder
18	VP-70018	Front End Plate
19	BB-05082	Ball Bearing
20	SP-30220	Spring Pin
21	VP-70021	Collar
22	VP-70022	Clamp Nut
23	VP-70023	Oil Seal
24	BB-62040	Ball Bearing
26	VP-70026	Internal Gear
27	NR-38030	Planet Pin (2 Req'd)
28	NR-15138	Needle Roller (22 Req'd)

29	VP-70029	Planet Gear (2 Req'd)
30	BB-60050	Ball Bearing
32	VP-70032	Planet Cage
33	BB-60000	Ball Bearing
34	ORP-0180	"O" Ring
35	VP-70035	Valve Stem
36	ORP-0060	"O" Ring
37	VP-70037	Valve Spring
38	VP-70038	Air Regulator
39	ORP-0080	"O" Ring
40	ORP-0110	"O" Ring
41	VP-70041	Valve Screw
42	VP-70042	Pad
43	VP-70043	Pad Nut
45	VP-70045	Bushing

SPECIFICATIONS:

Free Speed (R.P.M.)	2300
Recomm. Air Pressure	90 PSI
Av. Air Consumption	6 CFM
Air Inlet	1/4" NPT
Hose Size	3/8" I.D.
Spindle Size	5/8-11 UNC
Length	7-1/2"
Weight	4.4 LBS