

SPOT DRILL

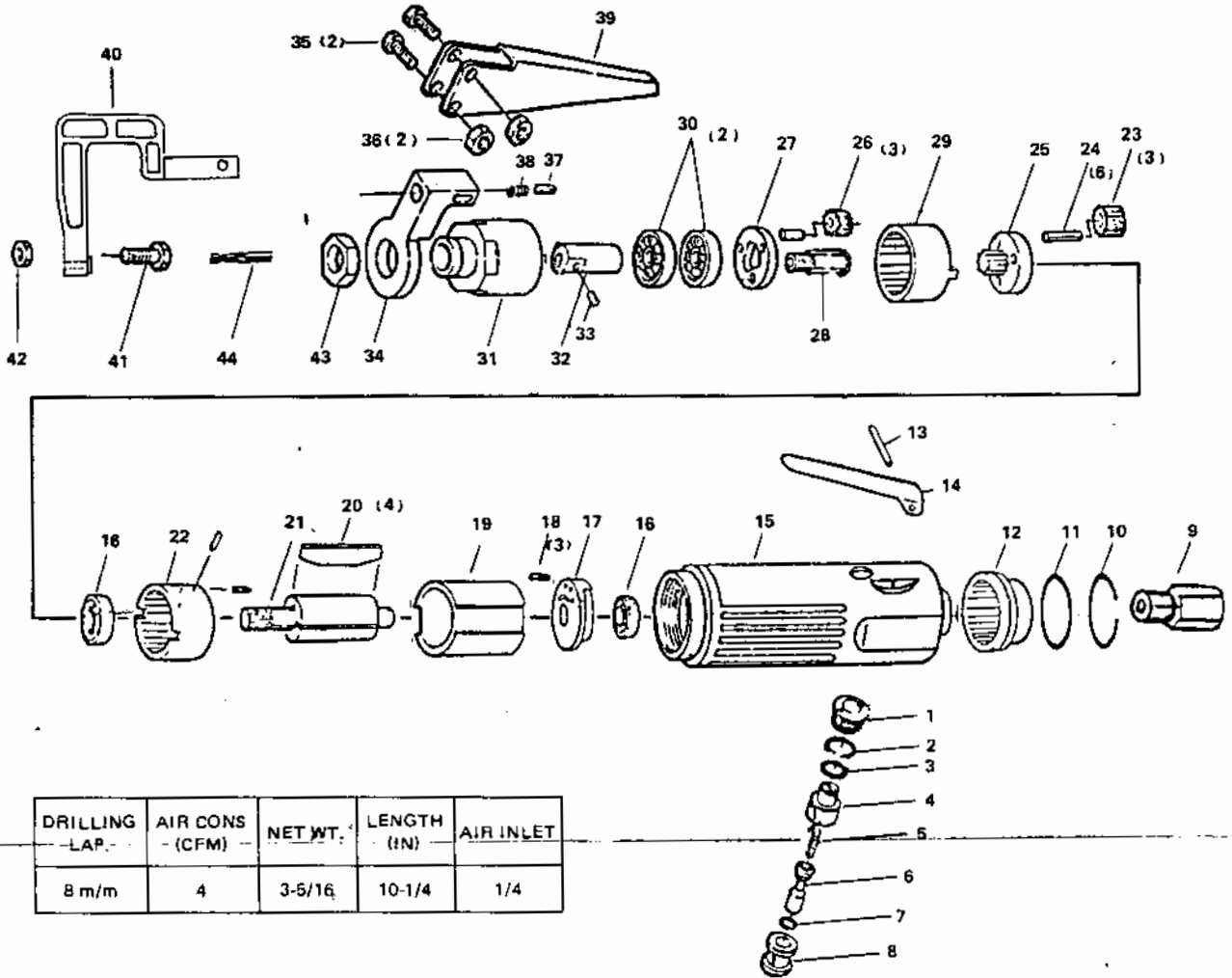

DRILLING LAP.	AIR CONS (CFM)	NET WT.	LENGTH (IN)	AIR INLET
8 m/m	4	3-5/16	10-1/4	1/4

PARTS LIST

Index No.	Part No.	Description	Qty. Per tool
1	0608001	Valve Screw	1
2	0608002	O-Ring	1
3	0608003	O-Ring	1
4	0608004	Air Controller	1
5	0608005	Valve Spring	1
6	0608006	Valve Stem	1
7	0608007	O-Ring	1
8	0608008	Valve Bushing	1
9	0608009	Inlet Bushing	1
10	0608010	Retainer Ring	1
11	0608011	O-Ring	1
12	0608012	Exhaust Sleeve	1
13	0608013	Spring-Pin	1
14	0608014	Throttle Lever	1
15	0608015	Motor Housing	1
16	0608016	Ball Bearing	2
17	0608017	Bear End Plate	1
18	0608018	Spring Pin	3
19	0608019	Cylinder	1
20	0608020	Rotor Blade	4
21	0608021	Rotor	1
22	0608022	Internal Gear With Flange Plate	1

Index No.	Part No.	Description	Qty. Per tool
23	0608023	Planet Gear	3
24	0608024	Planet Pin	6
25	0608025	Planet Carrier	1
26	0608026	Planet Gear	3
27	0608027	Planet Cage	1
28	0608028	Spindle Shaft	1
29	0608029	Internal Gear	1
30	0608030	Ball Bearing	2
31	0608031	Clamp Nut	1
32	0608032	Spindle	1
33	0608033	Set Screw	1
34	0608034	Arm Base	1
35	0608035	Hexagon Head Bolt	2
36	0608036	Hexagon Nut	1
37	0608037	Set Screw	1
38	0608038	Spring Niv	1
39	0608039	Grip Handle	1
40	0608040	Arm	1
41	060841	Cut in Adjusting Bolt	1
42	060842	Hexagon Nut	1
43	0608043	Lock Nut	1
44	0608044	Drill	1